

# Chipper canter RL-600 (logs) RC-600 (cants)



The chipper canter is intended for reducing logs when installed behind the LI-600 log infeed or for reducing two sided cants when installed behind a weep sawing infeed.

## Easy maintenance

The reducer is constructed of a box frame of welded steel plates. The chipper discs are mounted on two separate tables carried on round guides. The sliding surfaces are lubricated in oil bath.

## Flexible

The reducer unit contains of two chipper discs with longknives. The reducer discs can be supplied with pre or post cutting saw blades to give a sawn surface.

Steel guide plates are mounted on the outfeed side of the chipper discs. The chipper discs are equipped with pneumatic brakes.

The reducer has a sharp chain running through when placed to reduce logs and it has guide plates and a support bar running through the machine when placed to reduce cants.

## Servo-hydraulic networks

The chipper discs are laterally controlled by servo hydraulic networks for dimension setting. The network system contains servo cylinders, servo valves, base plate and electronic unit controlled by an overhead system. Alternatively the setting of the setting of the chipper discs can be done manually by a crankshaft. The set dimension is shown on a metric scale.

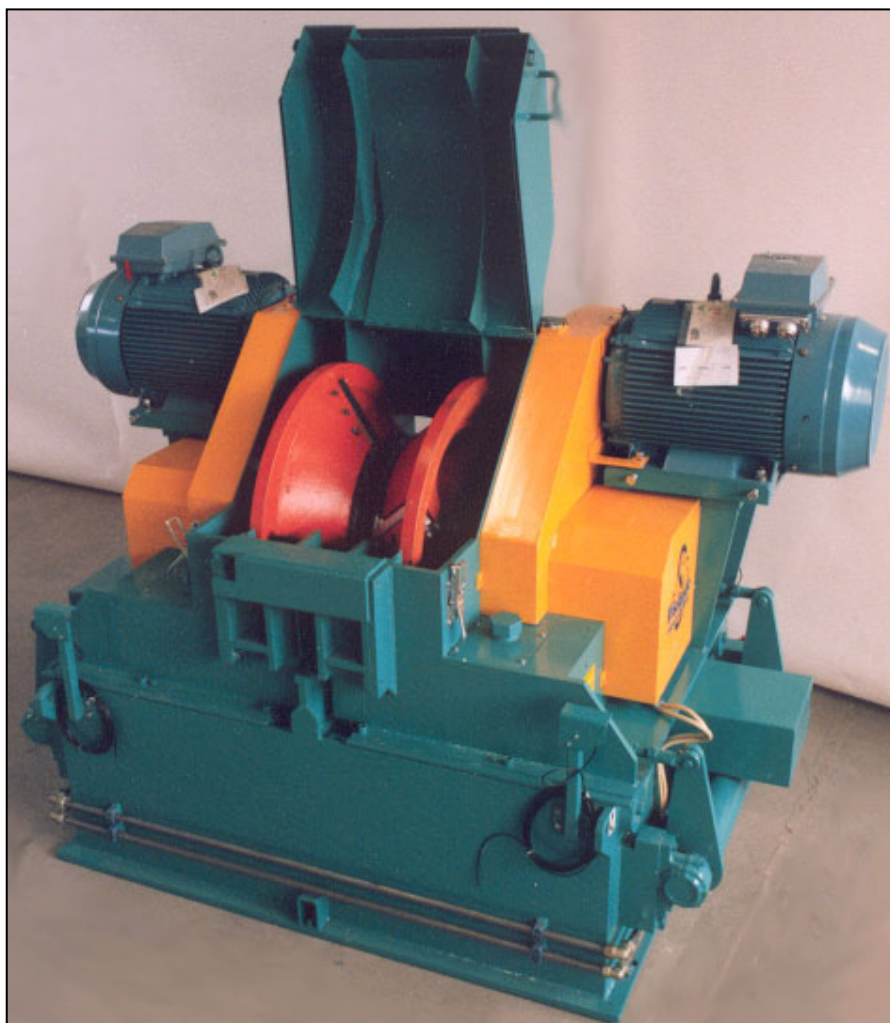

## Dimension

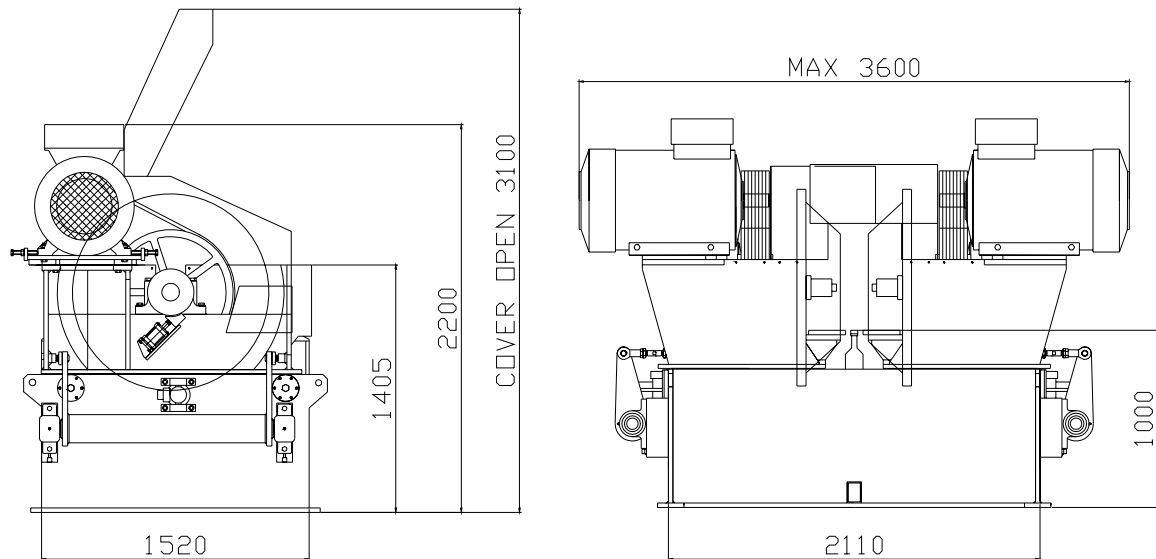

## Technical data

Min./Max. distance chipper discs .....	70/570 mm	
Diameter reducer discs .....	long knife disc..... 1120 mm	
	step-/spiral disc .....	1250 mm
Max. chipping .....	long knife disc.....	2x195 mm
	step-/spiral disc .....	2x150 mm
Min. log/cant length.....	2 m	

## Power requirement

Chipper discs.....2x55@132 kW

Air consumption..... 40 l/min

Air pressure..... 6 bar

Weight..... appr. 9.5 ton

## Accessories

- Sharp chain through the machine when used for round logs
- Driven overhead spiked roller used for round logs and operated by a pneumatic cylinder
- Driven vertical outfeeding rollers mounted on the tables
- Horizontal feed work with one bottom and one top roller with separate drives. The top feed roller is operated by pneumatic cylinders.
- Hydraulic power pack
- Step/spiral discs
- Key Knife

 **AriVislanda**  
SORB INDUSTRY

We reserve the right to make changes

Address  
AriVislanda AB  
Box 80  
SE-340 30 VISLANDA

Address  
AriVislanda AB  
Box 249  
SE-891 26 ÖRNSKÖLDSVIK

Phone, Vislanda  
+46 472 343 45  
Fax, Vislanda  
+46 472 343 49

Phone, Ö-vik  
+46 660 868 00  
Fax, Ö-vik  
+46 660 199 22

E-mail  
info@arivislanda.com  
Web  
www.arivislanda.com