

Rebuilding of feed wheel in KT-52/53

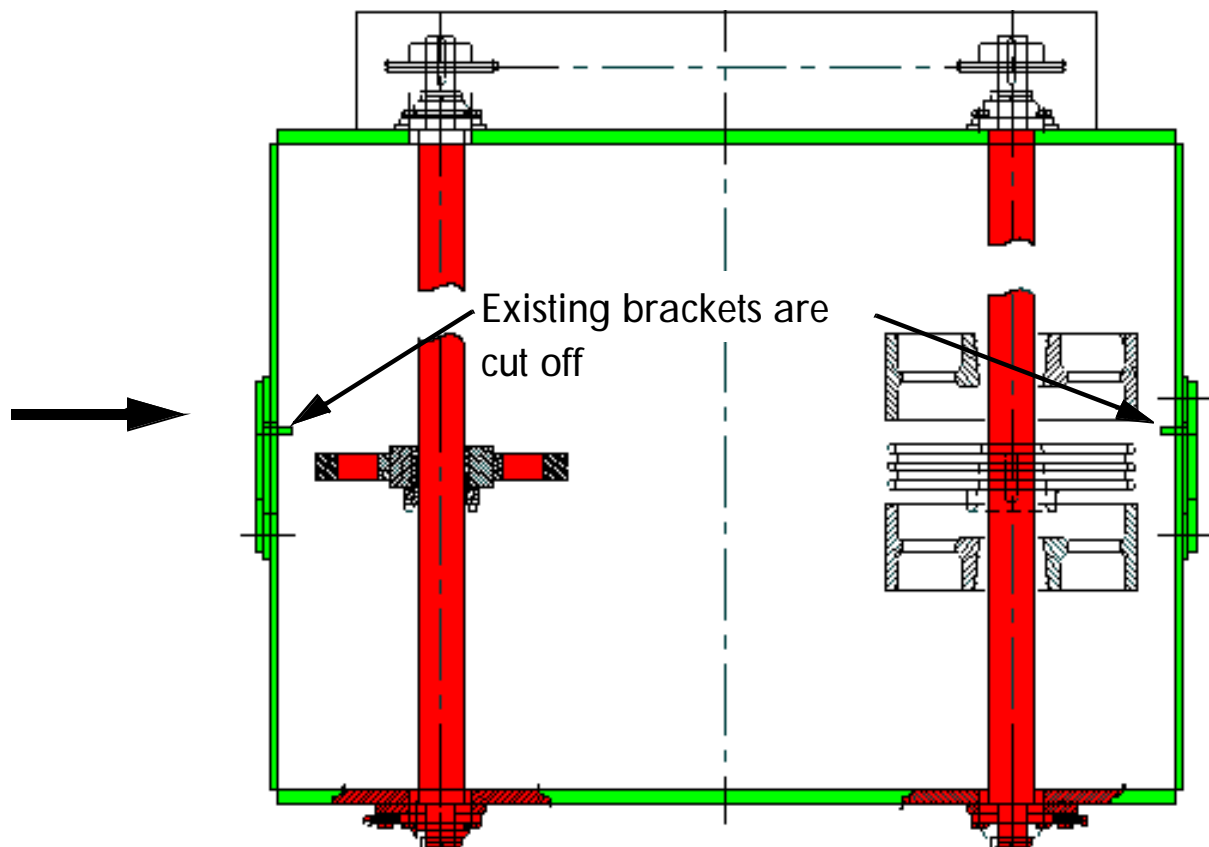

High speed requires more!

The edger is the saw machine which runs with the highest feed speed.

High feed speed means high stress in the parts. An extremely exposed part is the drive gear bearing for the feed chain and the support wheel.

That's the reason why AriVislanda has improved (strengthened) the design.

Rebuilding parts with through shafts and bearings outside the machine are available.

For more information, please contact AriVislandas After Sales.